

LOCATION PLAN (NOT TO SCALE)

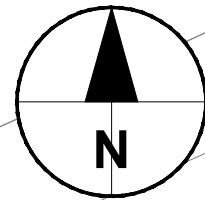
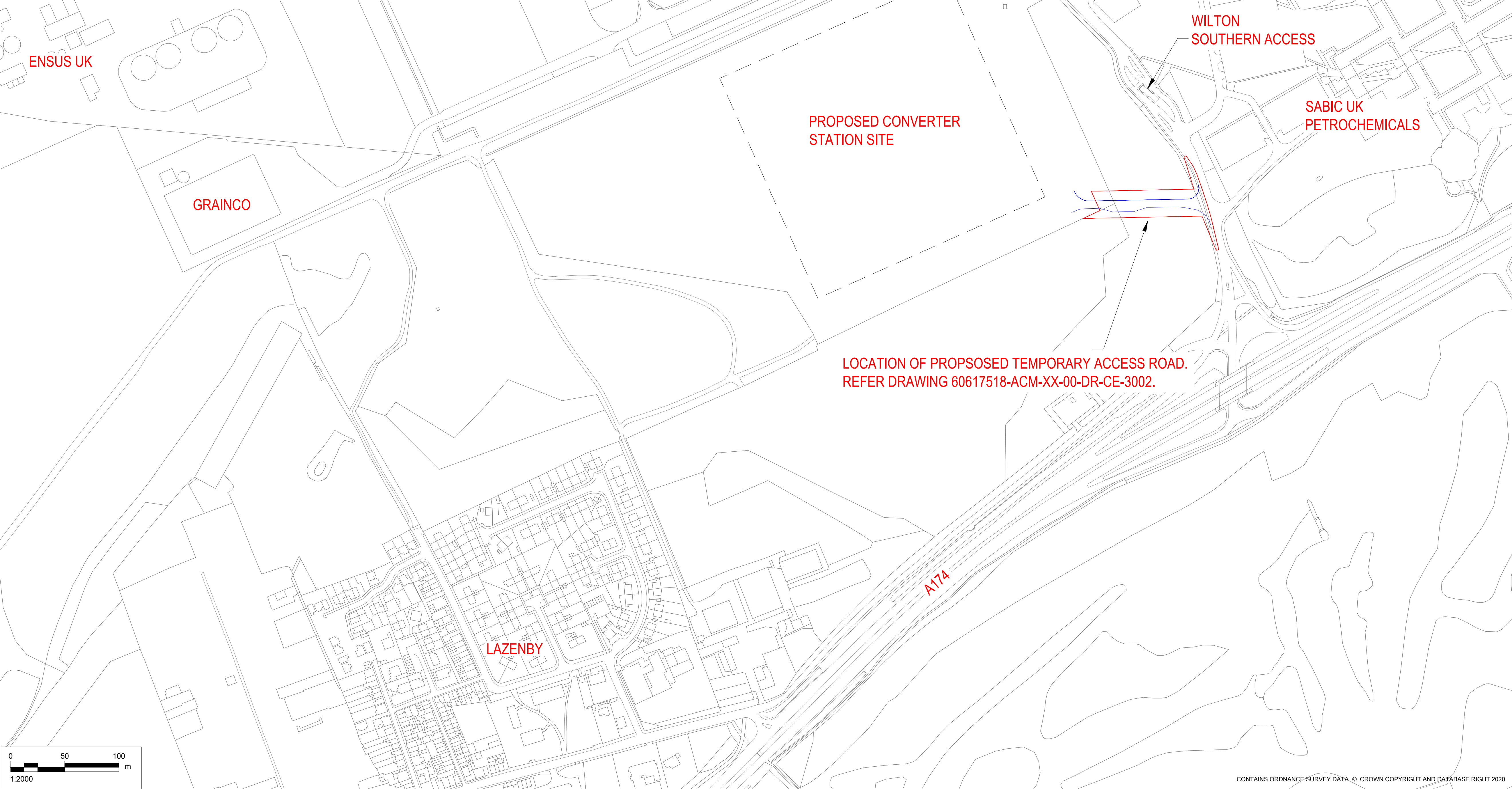

AECOM

Project
DOGGER BANK C & SOFIA
OFFSHORE WIND FARMS -
ONSHORE CONVERTER
STATION ENABLING WORKS

Client
**DOGGER BANK
WIND FARM**
by **SSE
Renewables** **equinor** **SOFIA
OFFSHORE
WIND FARM**

Consultant
Aecom
1 Tanfield
Edinburgh
EH3 5DA
United Kingdom
Fax +44 (0)131 301 8699
Tel +44 (0)131 301 8600
www.aecom.com

Notes

- PLANNING BOUNDARY
- PROPOSED TEMPORARY ACCESS ROAD

REFER TO DRAWING 60617518-ACM-XX-00-DR-CE-3002
FOR GENERAL ARRANGEMENT

ISSUE/REVISION			
C	08.09.20	ADDITIONAL NOTES ADDED	EPIC/CGY
B	26.08.20	REVISED REDLINE BOUNDARY	EPIC/CGY
A	17.08.20	NORTHERN ACCESS ADDED; REVISED REDLINE BOUNDARY	EPIC/CGY
Rev	Date	Description	Drn/Chk/Appr

Key Plan

Purpose Of Issue
FOR INFORMATION
Project Number
60617518
Sheet Title
SOUTHERN ACCESS ROAD -
SITE LOCATION PLAN
Sheet Number
60617518-ACM-XX-00-DR-CE-3001
Scale: 1:2000 **Rev:** C

This drawing has been prepared for the use of AECOM's client. It may not be used, modified, reproduced or relied upon by third parties, except as agreed by AECOM or as required by law. AECOM accepts no responsibility, and denies any liability, whatsoever, to any party that uses or relies on this drawing without AECOM's express written consent. Do not scale this document. All measurements must be obtained from the stated dimensions.

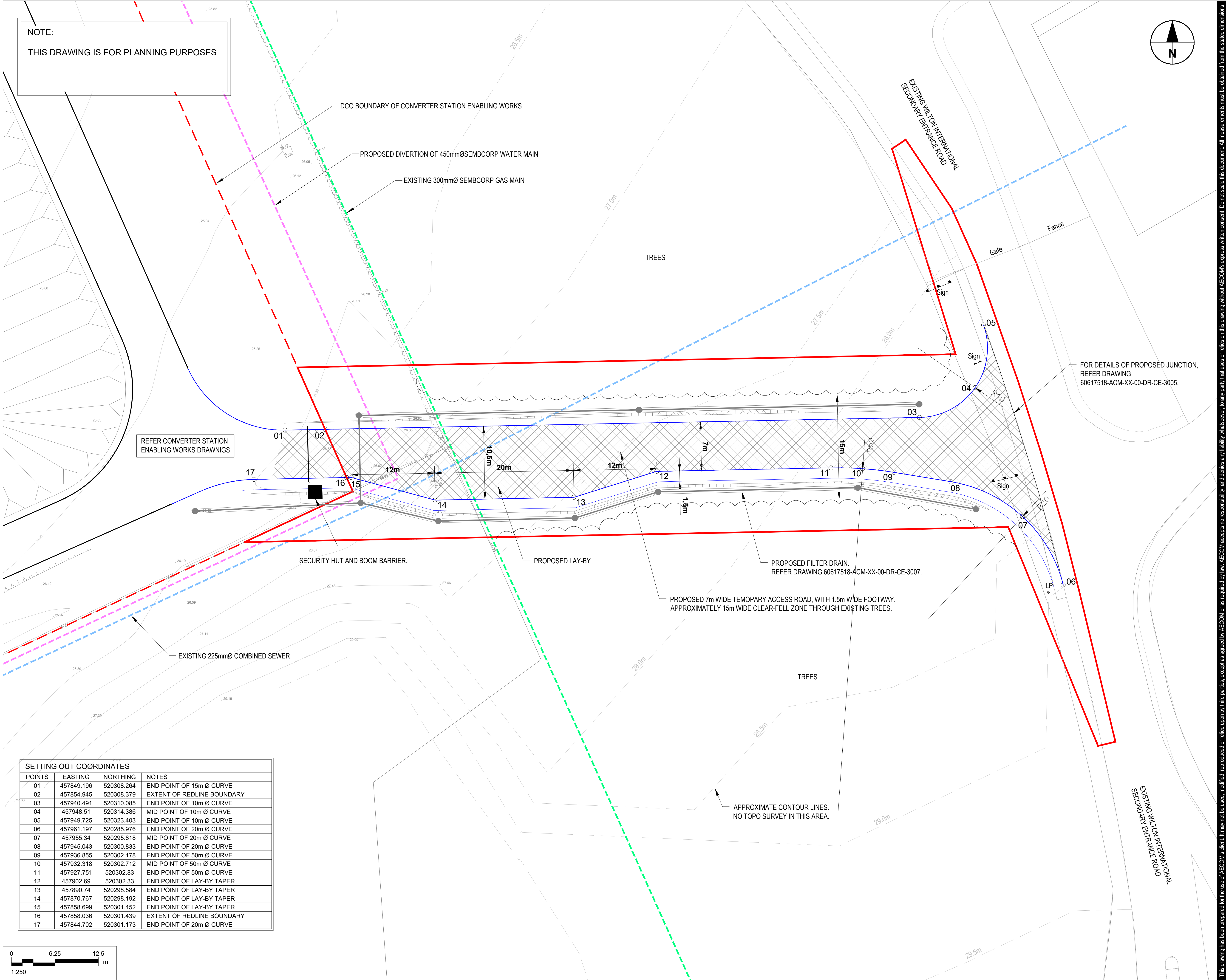

NOTE:
THIS DRAWING IS FOR PLANNING PURPOSES

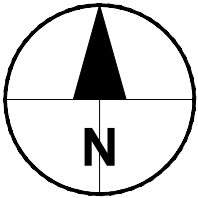

Project

DOGGER BANK C & SOFIA
OFFSHORE WIND FARMS -
ONSHORE CONVERTER
STATION ENABLING WORKS

Client

DOGGER BANK
WIND FARM

sse
Renewables equinor

SOFIA
OFFSHORE
WIND FARM

Consultant

Aecom
1 Tanfield
Edinburgh
EH3 5DA
United Kingdom
Fax +44 (0)131 301 8699
Tel +44 (0)131 301 8600
www.aecom.com

Notes



PLANNING BOUNDARY

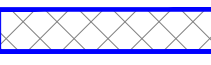

PROPOSED TEMPORARY
ACCESS ROAD

ISSUE/REVISION

Rev	Date	Description	Dwn/Chk/Appr
C	03.09.20	ADDITIONAL FILTER DRAIN ADDED	EPIC/CGY
B	26.08.20	LAY-BY ADDED. REVISED SETTING OUT	EPIC/CGY
A	17.08.20	REVISED REDLINE BOUNDARY	EPIC/CGY

Key Plan

Purpose Of Issue

FOR INFORMATION

Project Number

60617518

Sheet Title

SOUTHERN ACCESS ROAD
GENERAL ARRANGEMENT

Sheet Number

60617518-ACM-XX-00-DR-CE-3002

Scale: 1:250

Rev: C

This drawing has been prepared for the use of AECOM's client. It may not be used, modified, reproduced or relied upon by third parties, except as required by law. AECOM accepts no responsibility, and denies any liability whatsoever, to any party that uses or relies on this drawing without AECOM's express written consent. Do not scale this document. All measurements must be obtained from the stated dimensions.

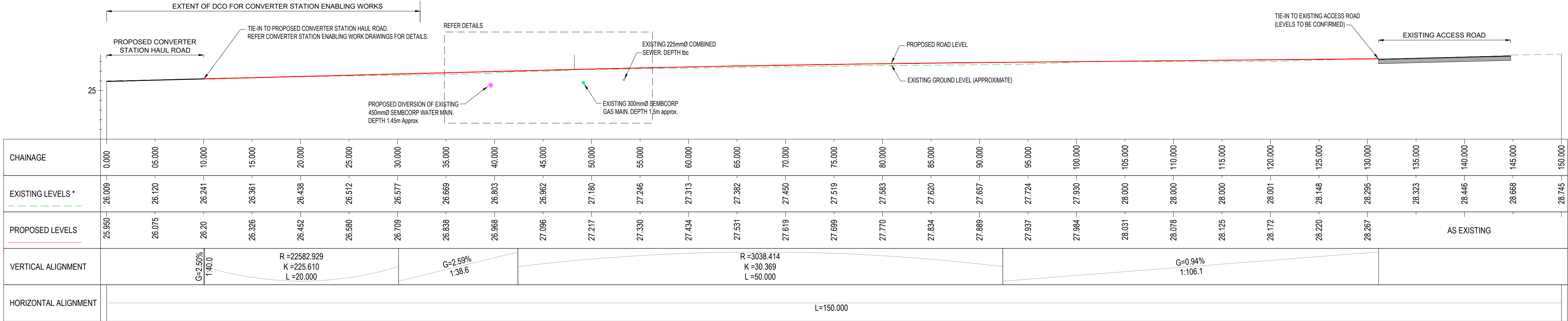
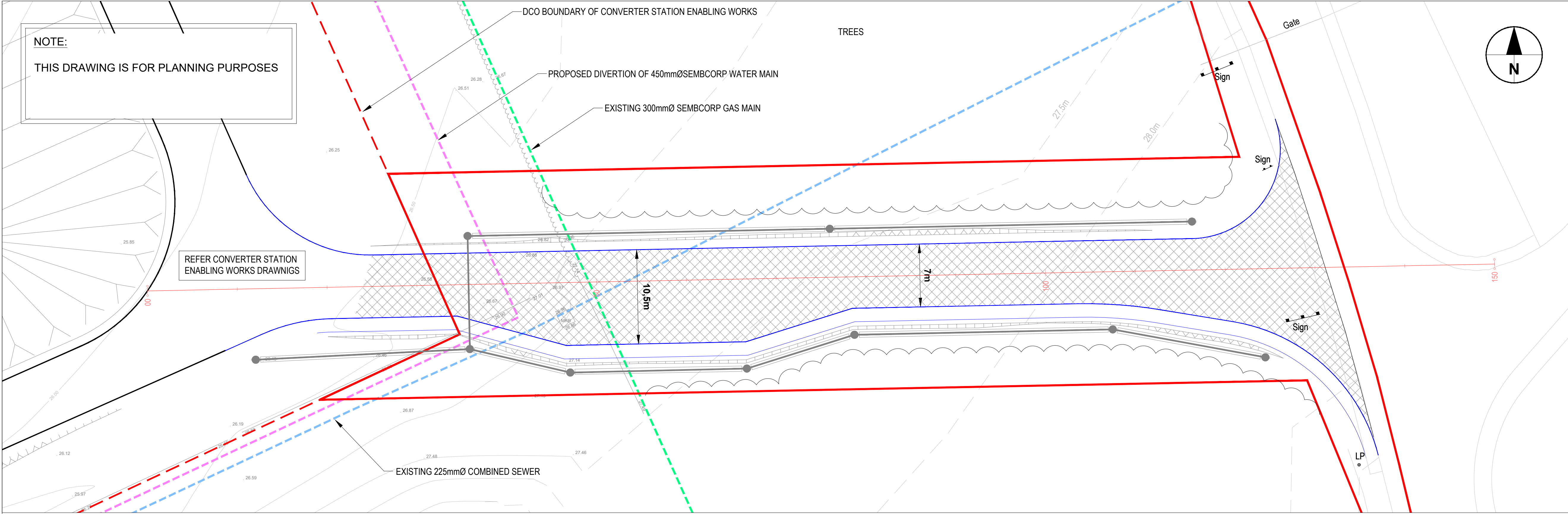

LONGITUDINAL SECTION
SCALE - HORIZ. 1:250, VERT. 1:250

* EXISTING LEVELS AFTER CHAINAGE 50m ARE APPROXIMATE ONLY, AND BASED ON LIDAR INFORMATION. NO TOPOGRAPHIC SURVEY INFORMATION FOR THIS AREA.

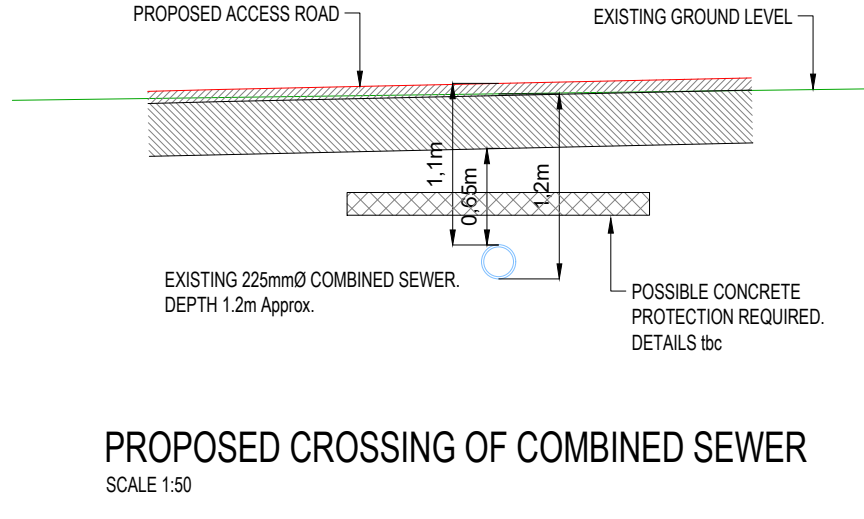
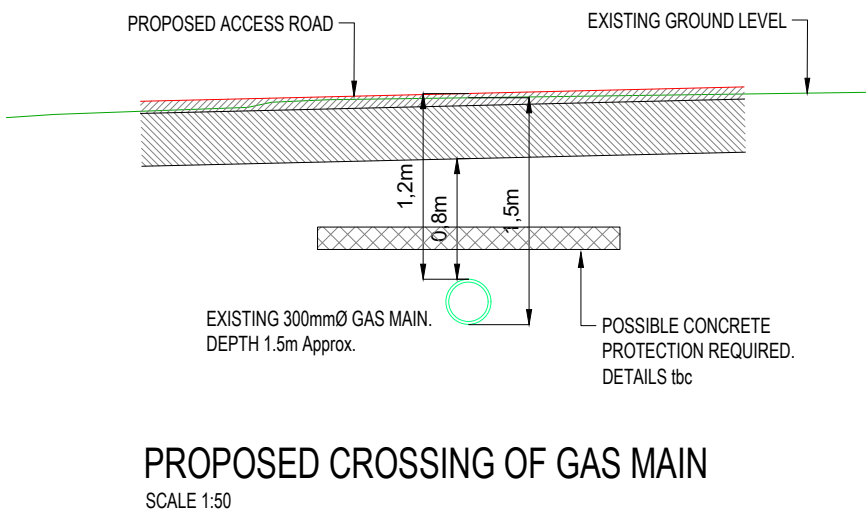
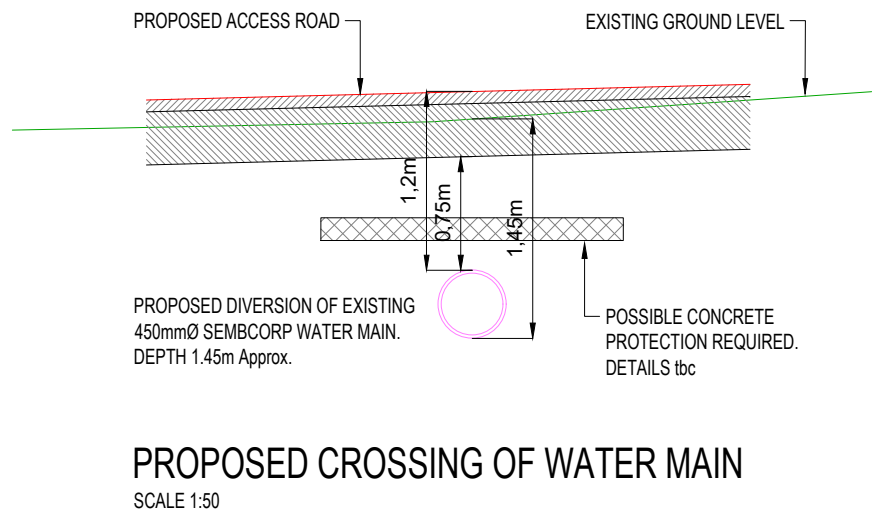

DEPTH OF EXISTING UTILITIES ARE APPROXIMATE ONLY. ALL EXISTING UTILITIES TO BE SITE-CHECKED PRIOR TO COMMENCEMENT OF WORKS.

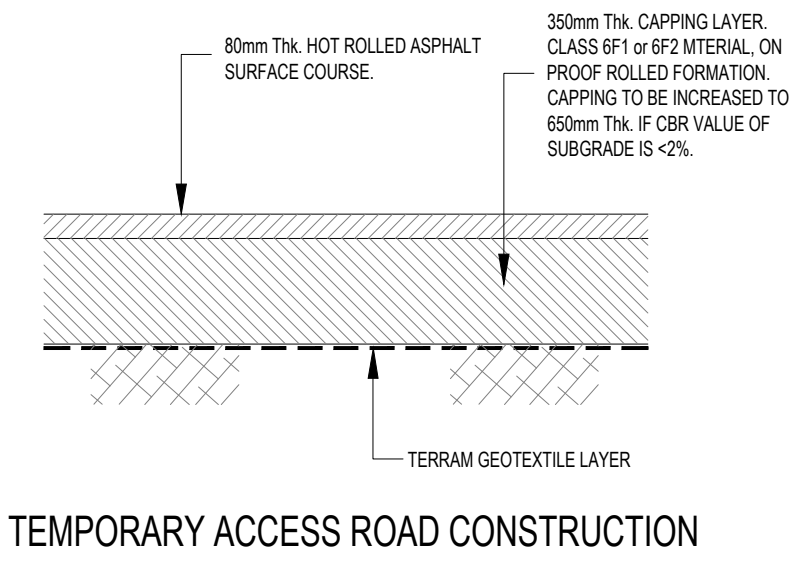

AECOM

Project
DOGGER BANK C & SOFIA
OFFSHORE WIND FARMS -
ONSHORE CONVERTER
STATION ENABLING WORKS

Client
DOGGER BANK
WIND FARM
BY
SSE
Renewables
equinor
SOFIA
OFFSHORE
WIND FARM

Consultant
Aecom
1 Tanfield
Edinburgh
EH3 5DA
United Kingdom
Fax +44 (0)131 301 8699
Tel +44 (0)131 301 8600
www.aecom.com

Notes

PLANNING BOUNDARY
PROPOSED TEMPORARY
ACCESS ROAD

ISSUE/REVISION

C	03.09.20	ADDITIONAL FILTER DRAIN ADDED	EPIC/COV/CGY
B	26.08.20	REVISED REDLINE BOUNDARY. LAY-BY ADDED.	EPIC/COV/CGY
A	17.08.20	REVISED REDLINE BOUNDARY	EPIC/COV/CGY
Rev	Date	Description	Drm/Chk/Appr

Key Plan

Purpose Of Issue

FOR INFORMATION

Project Number

60617518

Sheet Title

SOUTHERN ACCESS ROAD -
LONGITUDINAL SECTION

Sheet Number

60617518-ACM-XX-00-DR-CE-3003

Scale: 1:250 Rev: C

This drawing has been prepared for the use of AECOM's client. It may not be used, modified, reproduced or relied upon by third parties, except as agreed by AECOM or as required by law. AECOM accepts no responsibility, and denies any liability whatsoever, to any party that uses or relies on this drawing without AECOM's express written consent. Do not scale this document. All measurements must be obtained from the stated dimensions.

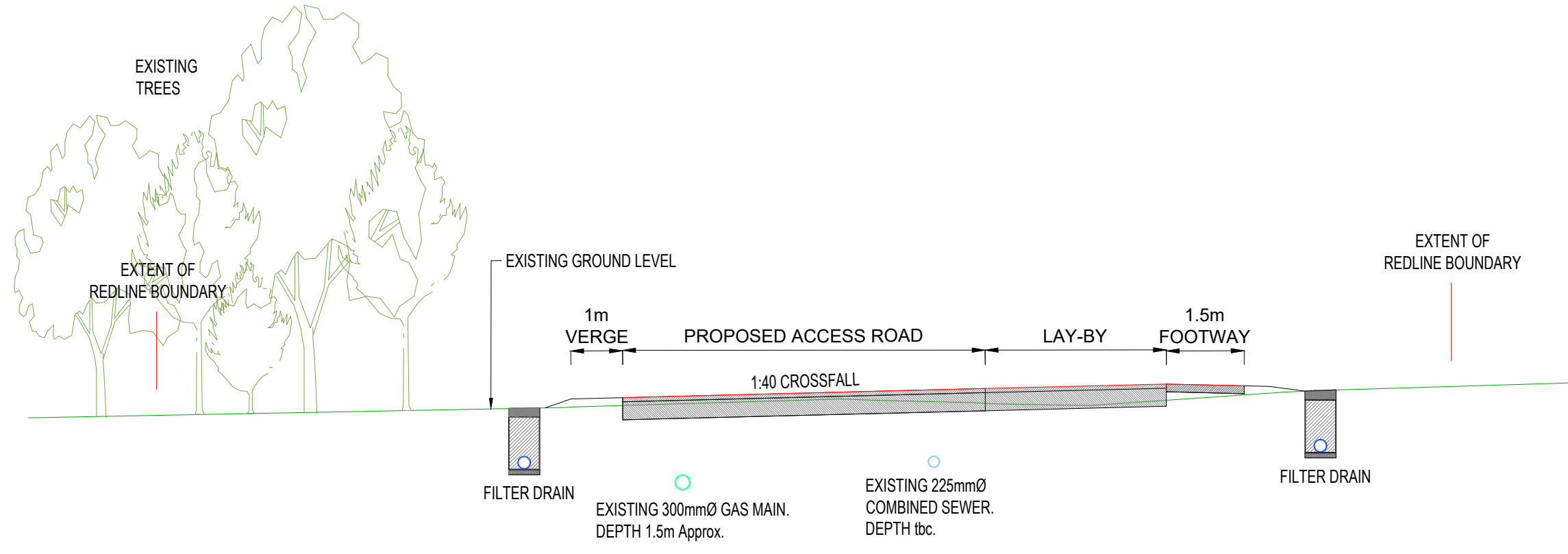
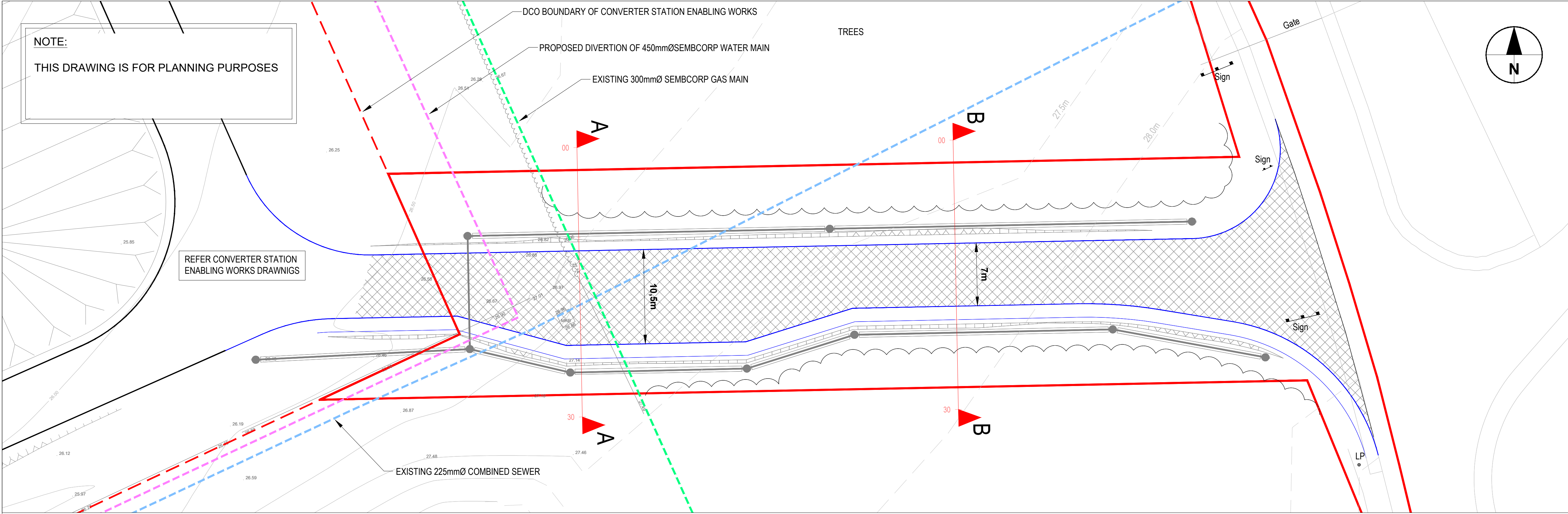

SECTION A-A
SCALE 1:100

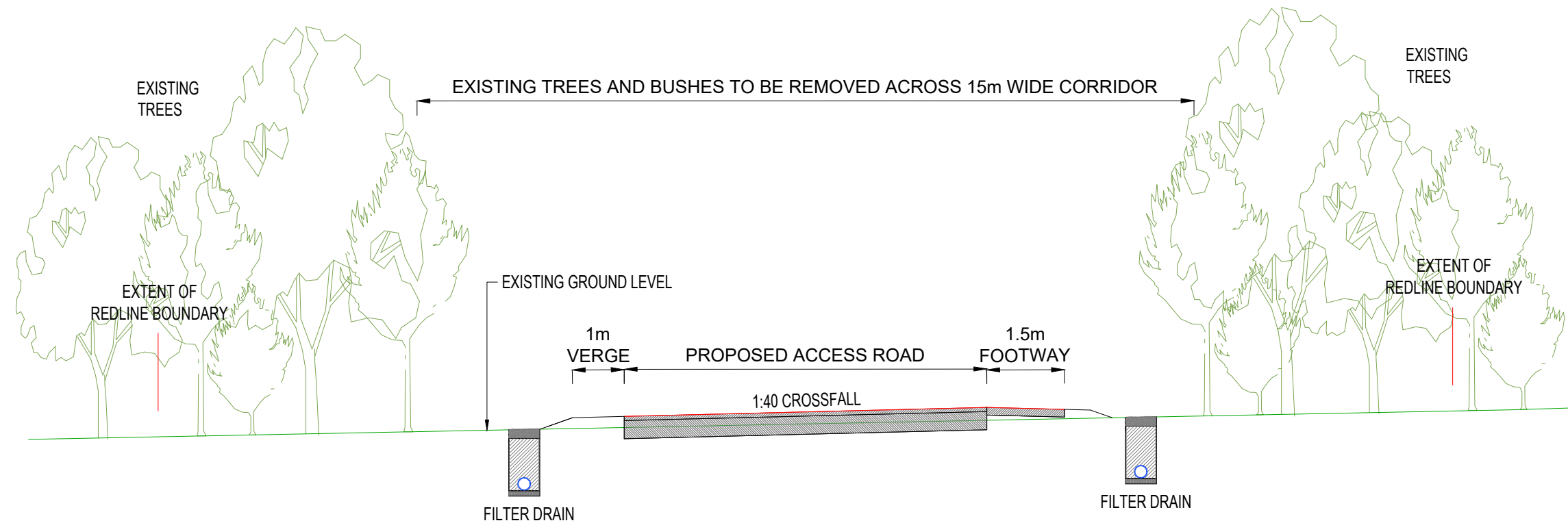

SECTION B-B
SCALE 1:100

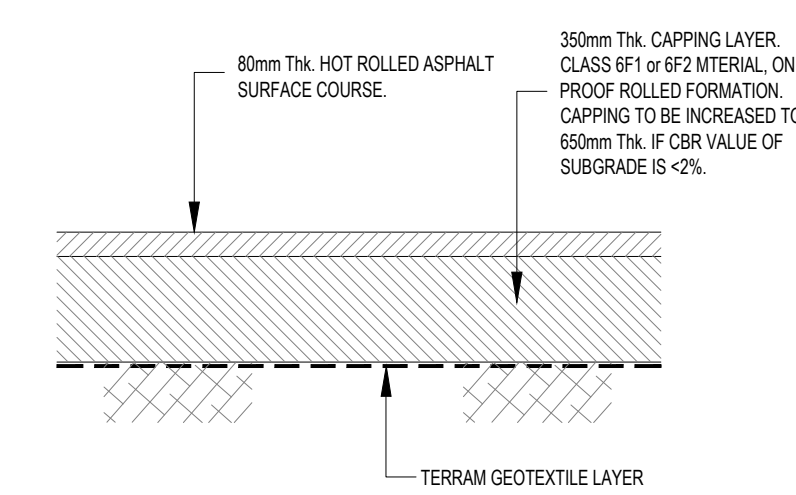

TEMPORARY ACCESS ROAD CONSTRUCTION



Project
DOGGER BANK C & SOFIA
OFFSHORE WIND FARMS -
ONSHORE CONVERTER
STATION ENABLING WORKS

Client
DOGGER BANK
WIND FARM
SSE
Renewables
equinor
SOFIA
OFFSHORE
WIND FARM

Consultant
Aecom
1 Tanfield
Edinburgh
EH3 5DA
United Kingdom
Fax +44 (0)131 301 8699
Tel +44 (0)131 301 8600
www.aecom.com

Notes

PLANNING BOUNDARY
PROPOSED TEMPORARY
ACCESS ROAD

ISSUE/REVISION

Rev	Date	Description	Dwn/Chk/Appr
C	02.09.20	ADDITIONAL FILTER DRAIN ADDED	EPIC/CGY
B	26.08.20	LAY-BY ADDED. SECTION A-A AMENDED	EPIC/CGY
A	17.08.20	REVISED REDLINE BOUNDARY	EPIC/CGY

Key Plan

Purpose Of Issue

FOR INFORMATION

Project Number

60617518

Sheet Title

SOUTHERN ACCESS ROAD -
TYPICAL CROSS SECTIONS

Sheet Number

60617518-ACM-XX-00-DR-CE-3004

Scale: As shown Rev: C

ISO A1 594mm x 841mm
Project Management Initials: Designer: EP
Checked: CGY
Approved: CGY
Last saved by: E:\AN\PROJ\F00T(2020.08.28)_Last Plotted: 2020.09.04
Filename: Z:\UK\UKED\1\JOBS\PR-448660_TSA_OFFSHORE_CABLE_ROUTE\000_CAD_GIS\910_CAD\DC\DCB\60617518-ACM-XX-00-DR-CE-3005.DWG

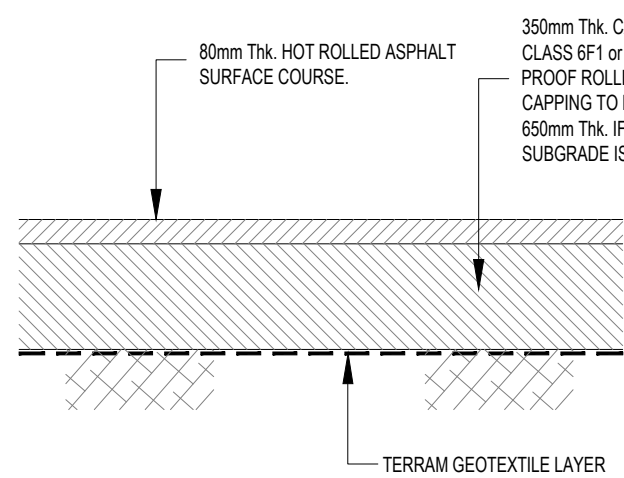
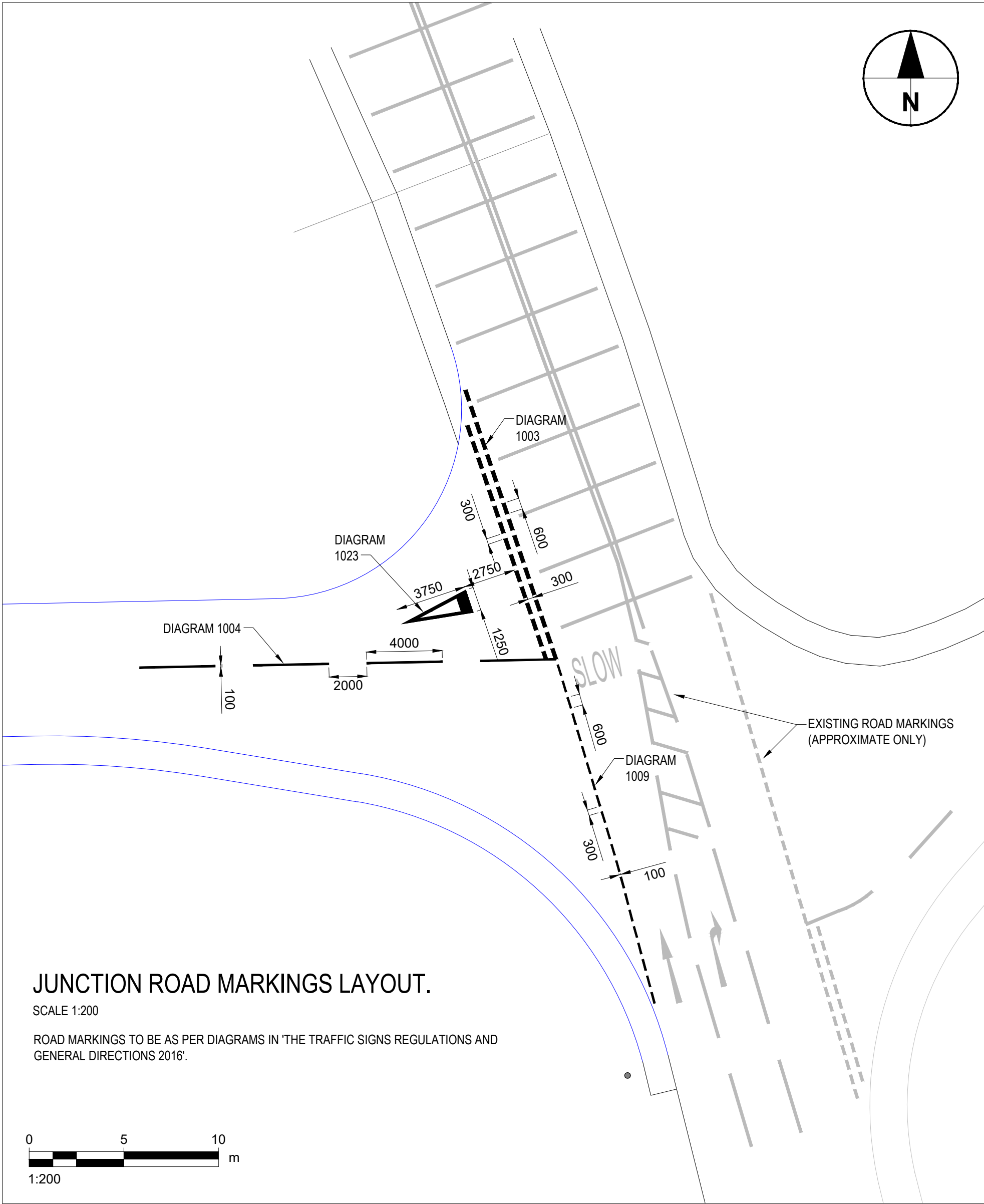
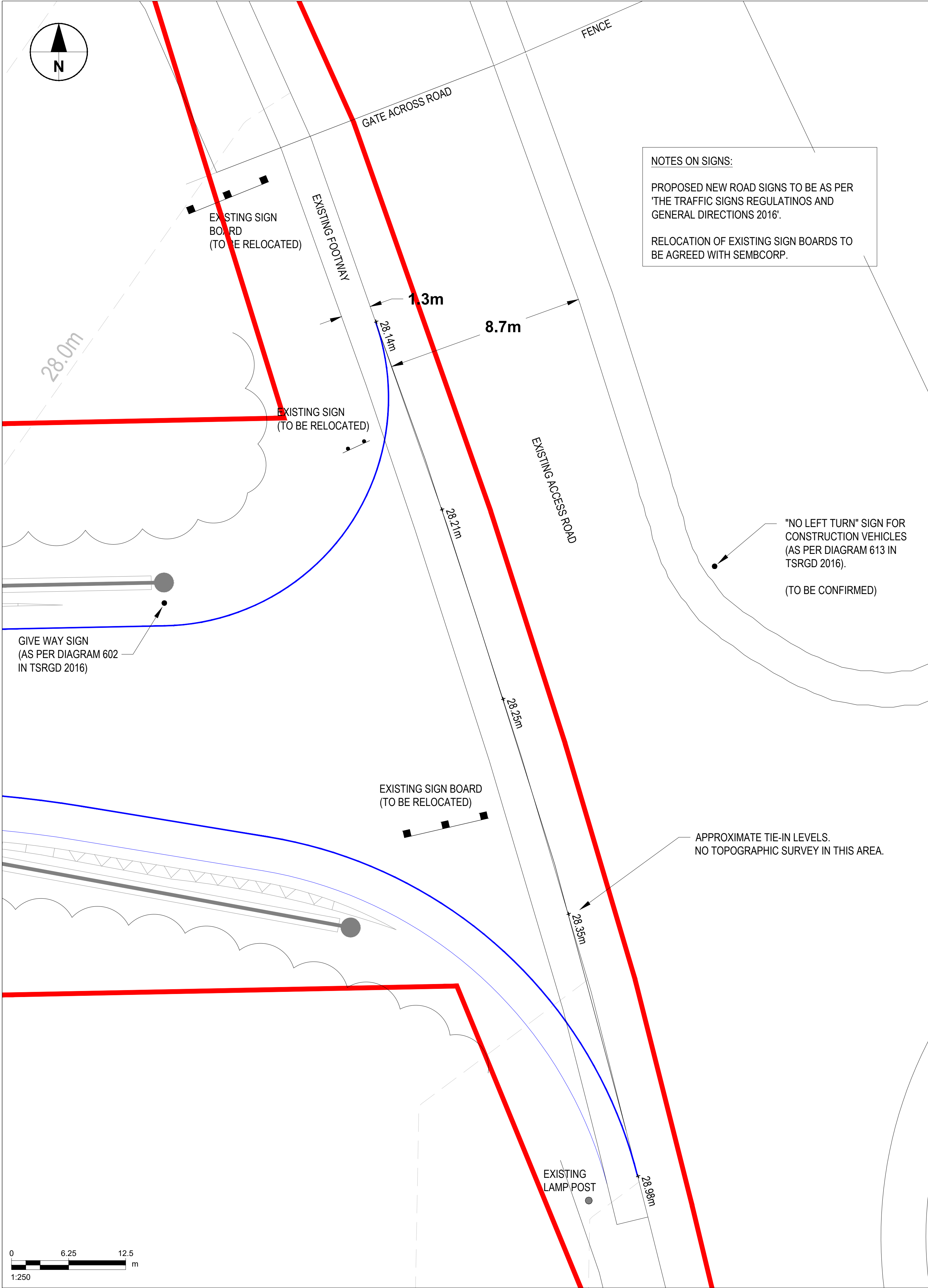

TEMPORARY ACCESS ROAD CONSTRUCTION

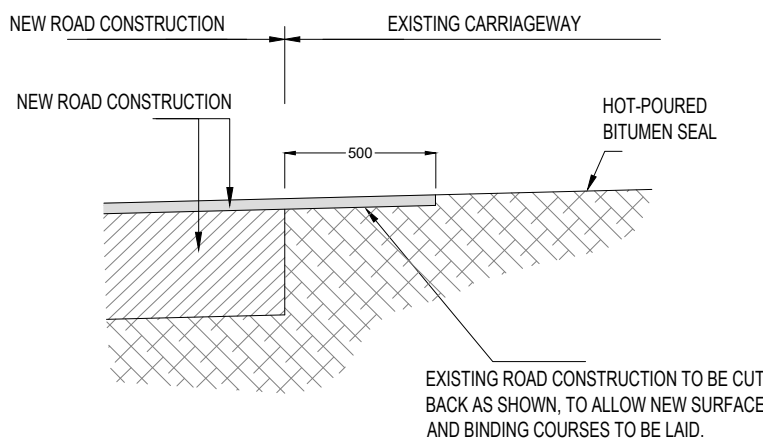

DETAIL OF ROAD TIE-IN TO EXISTING CARRIAGEWAY

NOTE:

THIS DRAWING IS FOR PLANNING PURPOSES



Project

DOGGER BANK C & SOFIA
OFFSHORE WIND FARMS -
ONSHORE CONVERTER
STATION ENABLING WORKS

Client

DOGGER BANK
WIND FARM
BY
SSE Renewables equinor SOFIA
OFFSHORE
WIND FARM

Consultant

Aecom
1 Tanfield
Edinburgh
EH3 5DA
United Kingdom
Fax +44 (0)131 301 8699
Tel +44 (0)131 301 8600
www.aecom.com

Notes

PLANNING BOUNDARY

PROPOSED TEMPORARY ACCESS ROAD

ISSUE/REVISION					
C	03.09.20	ADDITIONAL FILTER DRAIN ADDED	EPIC/CGY		
B	26.08.20	REVISED REDLINE BOUNDARY	EPIC/CGY		
A	17.08.20	NOTES ADDED FOR SIGNS, REVISED REDLINE BOUNDARY	EPIC/CGY		
Rev	Date	Description			Dm/Chk/Appr

Key Plan

Purpose Of Issue

FOR INFORMATION

Project Number

60617518

Sheet Title

SOUTHERN ACCESS ROAD -
PROPOSED JUNCTION WITH
EXISTING ACCESS ROAD

Sheet Number

60617518-ACM-XX-00-DR-CE-3005

Scale: 1:250 **Rev:** C

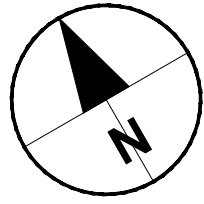
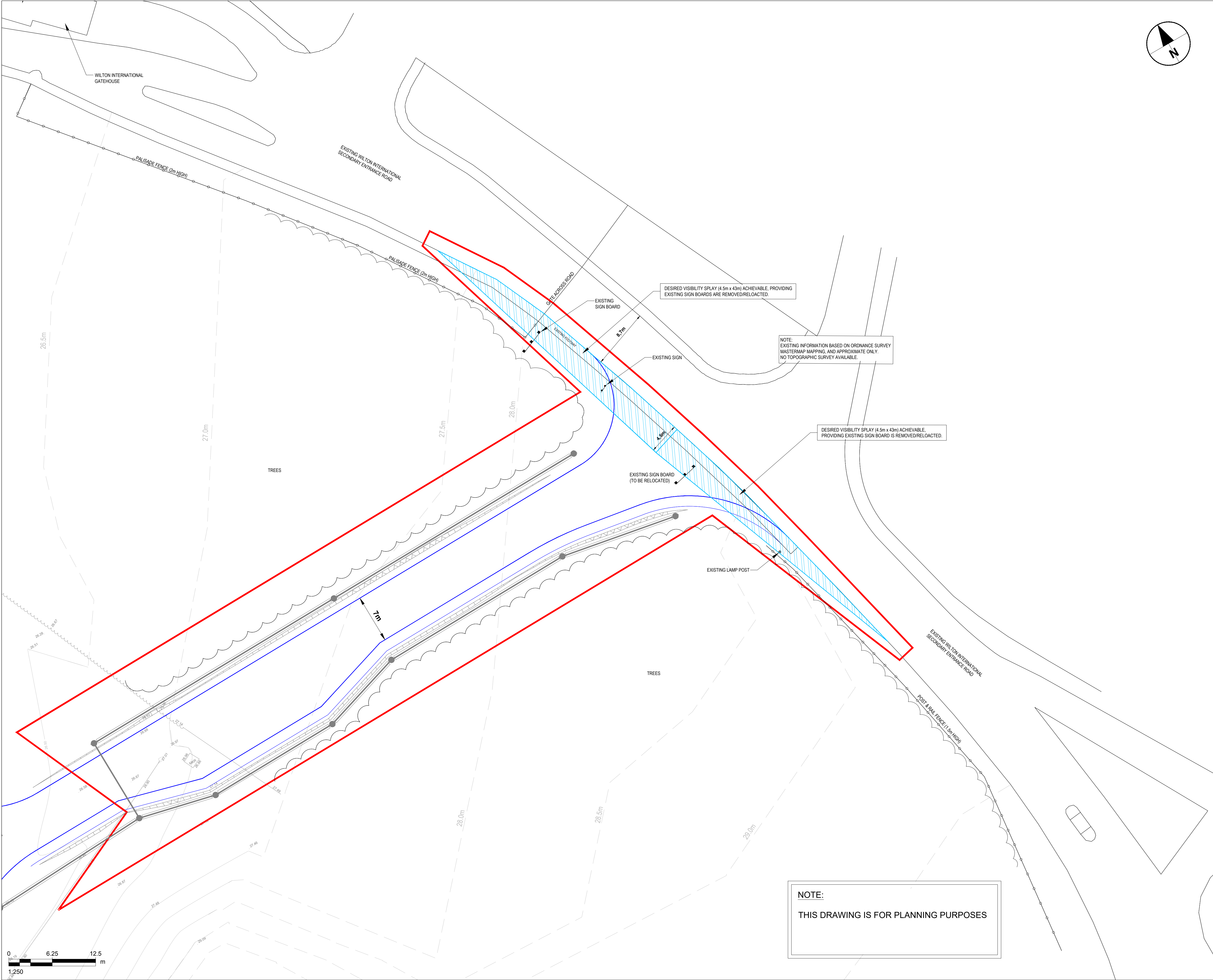

Project

DOGGER BANK C & SOFIA
OFFSHORE WIND FARMS -
ONSHORE CONVERTER
STATION ENABLING WORKS

Client

DOGGER BANK WIND FARM
by **SSE Renewables** **equinor**

SOFIA OFFSHORE WIND FARM

Consultant

Aecom
1 Tanfield
Edinburgh
EH3 5DA
United Kingdom
Fax +44 (0)131 301 8699
Tel +44 (0)131 301 8600
www.aecom.com

- Notes**
- FOR PROPOSED ACCESS GENERAL ARRANGEMENT, REFER DRAWING 60617518-ACM-XX-00-DR-CE-3002.
 - DESIRED VISIBILITY DISTANCES ARE BASED ON GUIDANCE FROM SCP TRANSPORT TRAFFIC CONSULTANTS.
- DESIRED VISIBILITY SPPLAY -
4.5m (x-distance) x 43m (y-distance)
- 4.5m x 43m VISIBILITY SPPLAY

PLANNING BOUNDARY

PROPOSED TEMPORARY ACCESS ROAD

ISSUE/REVISION				
C	03.09.20	REVISED ROAD LAYOUT	EPIC/CGY	
B	25.08.20	REVISED REDLINE BOUNDARY	EPIC/CGY	
A	17.08.20	SPALLS AMENDED BASED ON CLIENT ADVICE	EPIC/CGY	
Rev	Date	Description		Dm/Chk/Appr

Key Plan

Purpose Of Issue

FOR INFORMATION

Project Number

60617518

Sheet Title

SOUTHERN ACCESS ROAD -
VISIBILITY SPPLAYS

Sheet Number

60617518-ACM-XX-00-DR-CE-3006

Scale: 1:250

Rev: C

This drawing has been prepared for the use of AECOM's client. It may not be used, modified, reproduced or relied upon by third parties, except as agreed by AECOM or as required by law. AECOM accepts no responsibility, and denies any liability whatsoever, to any party that uses or relies on this drawing without AECOM's express written consent. Do not scale this document. All measurements must be obtained from the stated dimensions.

ISO A1 594mm x 841mm
Approved: CGY
Checked: CGY
Designer: EP
Project Management Initials:
Last saved by: E:\AN\PROJ\FOOT\2020\08\28\ Last Plotted: 2020.09.02
Filename: Z:\UK\UKED\1\DOBS\PR-448660_TSA_OFFSHORE_CABLE_ROUTE\8000_CAD_GIS\910_CAD\DC\DCB\60617518-ACM-XX-00-DR-CE-3007.DWG

NOTE:
THIS DRAWING IS FOR PLANNING PURPOSES

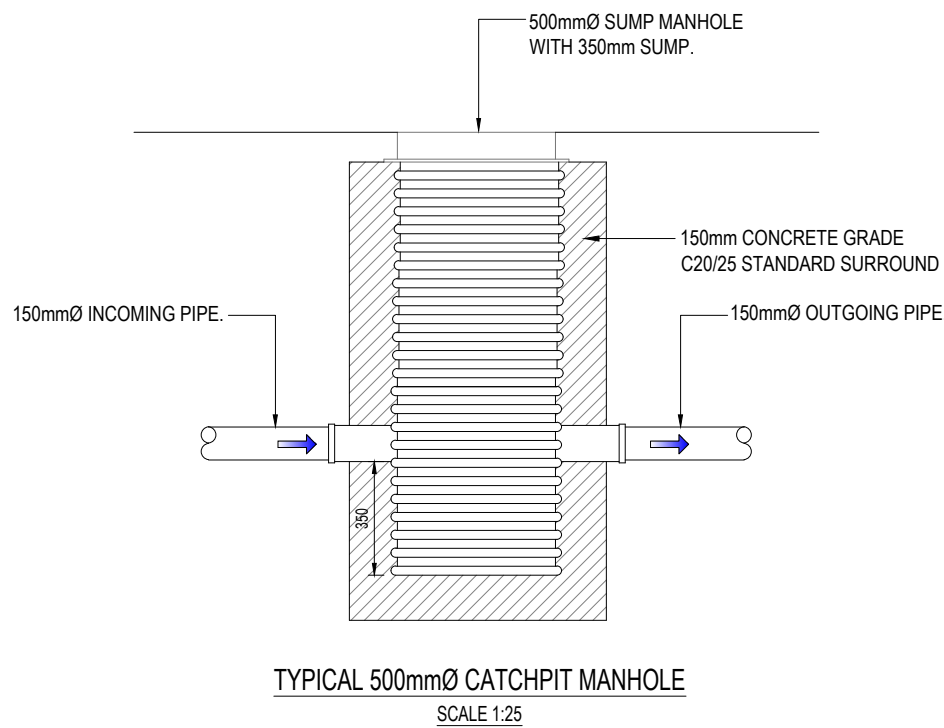
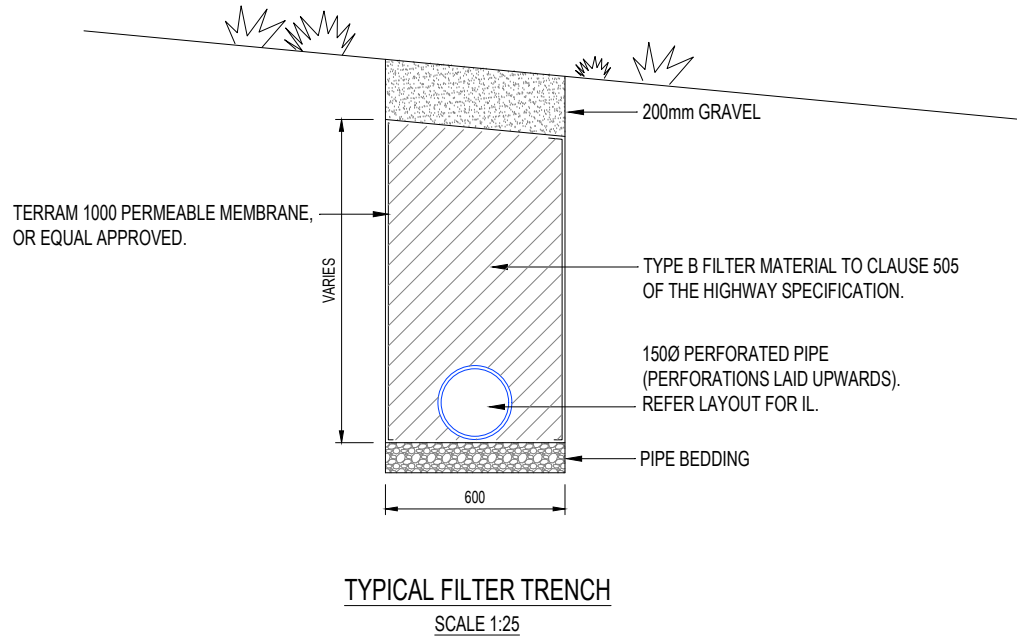
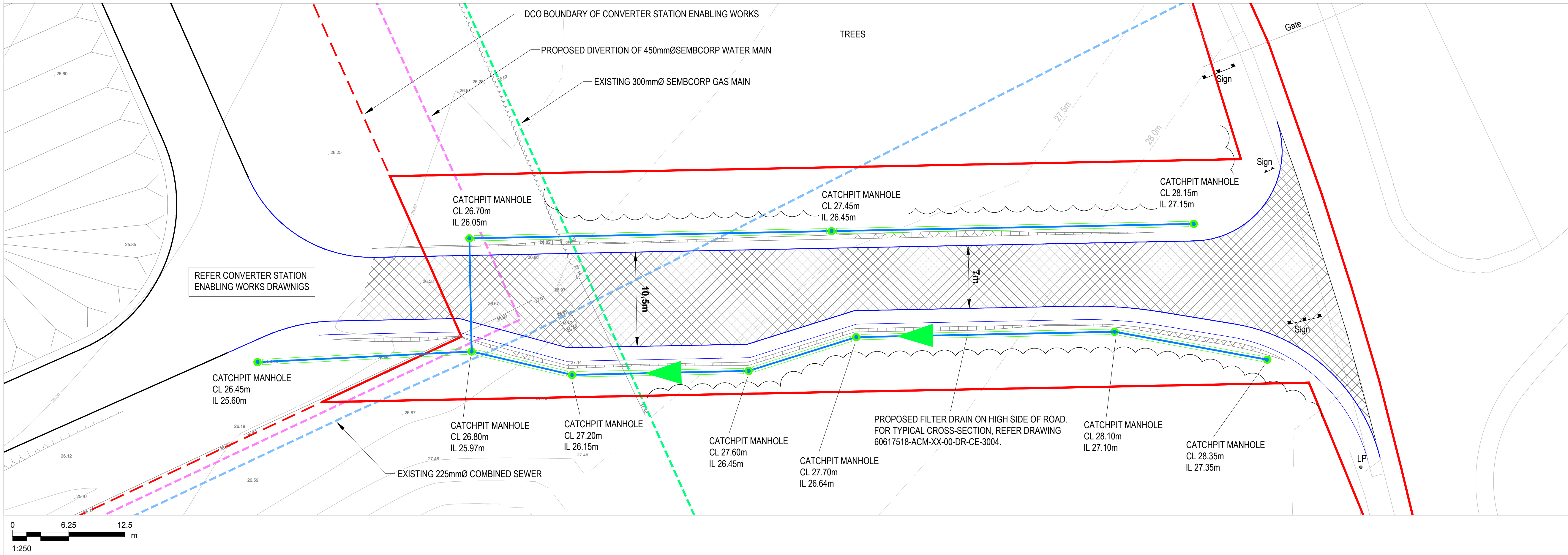
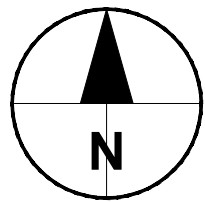

AECOM

Project
DOGGER BANK C & SOFIA
OFFSHORE WIND FARMS -
ONSHORE CONVERTER
STATION ENABLING WORKS

Client
DOGGER BANK
WIND FARM
SSE Renewables equinor SOFIA
OFFSHORE
WIND FARM

Consultant
Aecom
1 Tanfield
Edinburgh
EH3 5DA
United Kingdom
Fax +44 (0)131 301 8699
Tel +44 (0)131 301 8600
www.aecom.com

- Notes**
- PLANNING BOUNDARY
 - PROPOSED TEMPORARY ACCESS ROAD
 - PROPOSED FILTER DRAIN
 - PROPOSED CATCHPIT MANHOLE

ISSUE/REVISION				
C	02.09.20	ADDITIONAL FILTER DRAIN ADDED	EPIC/CGY	
B	26.08.20	LAY-BY ADDED. DRAINAGE AMENDED TO SUIT	EPIC/CGY	
A	17.08.20	REVISED REDLINE BOUNDARY	EPIC/CGY	
Rev	Date	Description	Dm/Chk/Appr	

Key Plan

Purpose Of Issue
FOR INFORMATION
Project Number
60617518
Sheet Title
SOUTHERN ACCESS ROAD
- PROPOSED DRAINAGE
Sheet Number
60617518-ACM-XX-00-DR-CE-3007
Scale: As shown **Rev:** C

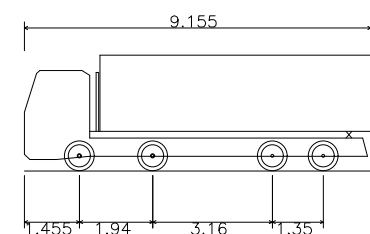
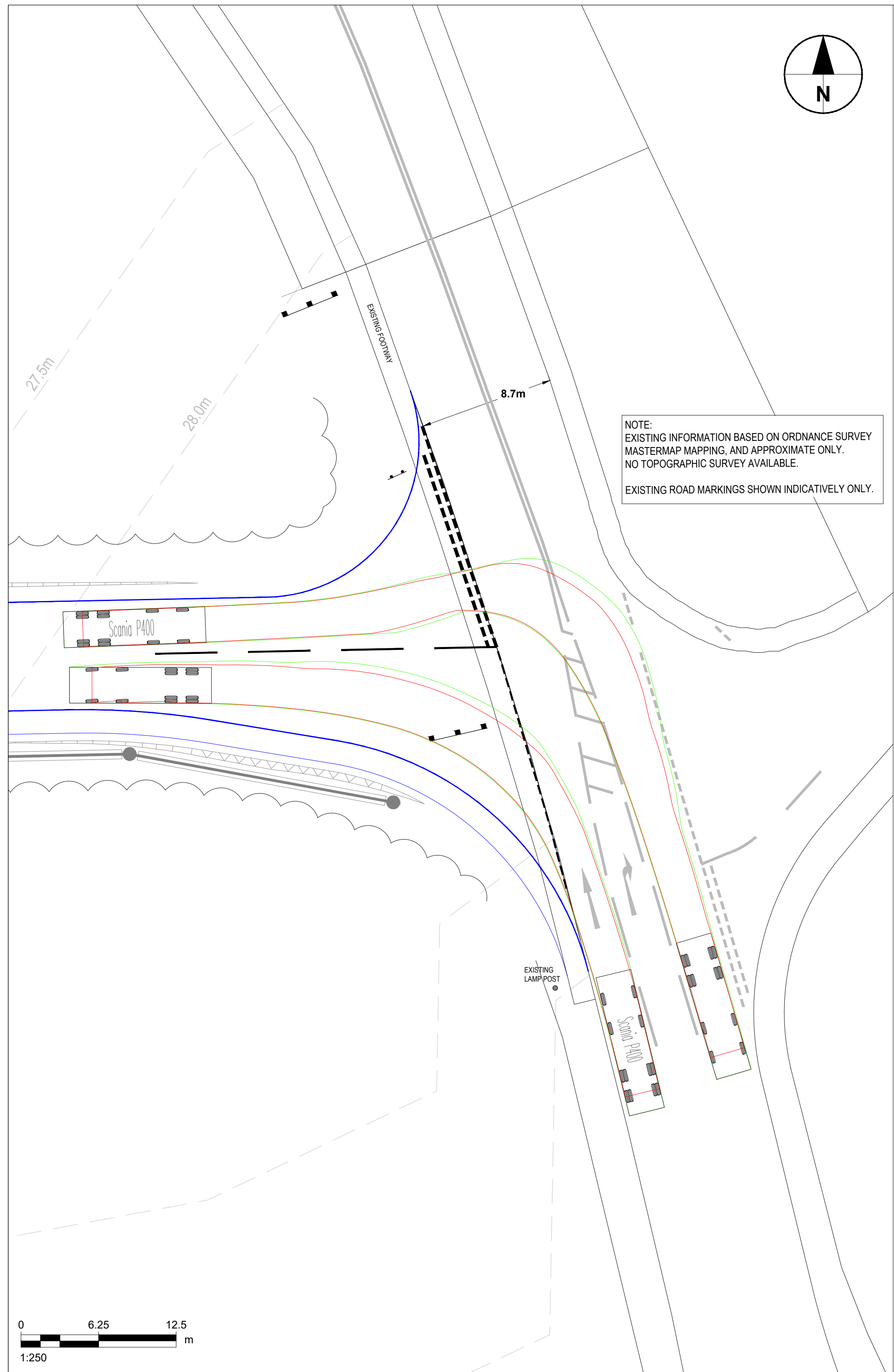

Scania P400	
Overall Length	9.155m
Overall Width	2.315m
Overall Body Height	3.062m
Min Body Ground Clearance	0.302m
Track Width	2.250m
Lock to lock time	6.00s
Max Wheel Angle	40.00°

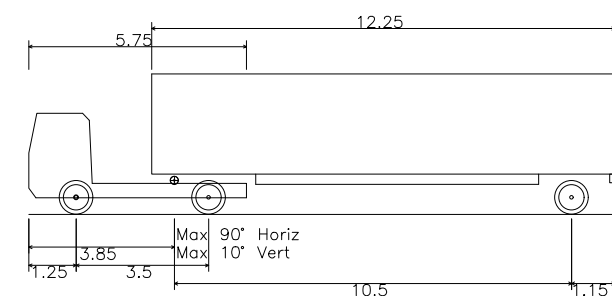
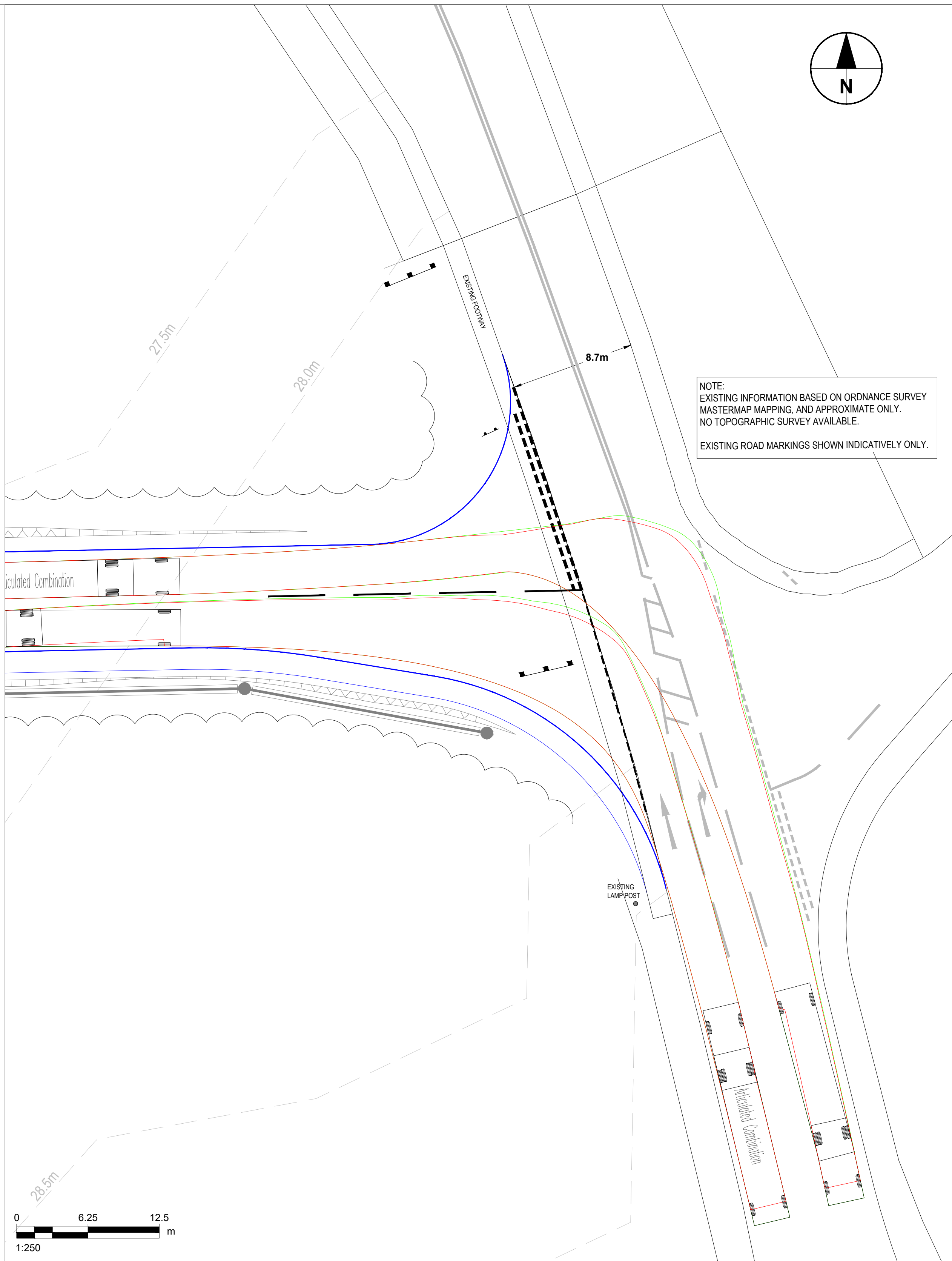

Articulated Combination	
Overall Length	15.500m
Overall Width	2.550m
Overall Body Height	3.713m
Min Body Ground Clearance	0.436m
Track Width	2.550m
Lock to lock time	4.00s
Kerb to Kerb Turning Radius	7.500m

NOTE:

THIS DRAWING IS FOR PLANNING PURPOSES



Project

DOGGER BANK C & SOFIA
OFFSHORE WIND FARMS -
ONSHORE CONVERTER
STATION ENABLING WORKS

Client



Consultant

Aecom
1 Tanfield
Edinburgh
EH3 5DA
United Kingdom
Fax +44 (0)131 301 8699
Tel +44 (0)131 301 8600
www.aecom.com

Notes

ISSUE/REVISION

Rev	Date	Description	Drm/Chk/Appr

Key Plan

Purpose Of Issue

FOR INFORMATION

Project Number

Sheet Title

SOUTHERN ACCESS ROAD - VEHICLE TRACKING

Sheet Number

60617518-ACM-XX-00-DR-CE-3008

Scale: 1:250

ev: