

NOTICE TO MARINERS



DOGGER BANK OFFSHORE WIND FARM

DATE OF ISSUE:	01/04/2022
NOTICE TO MARINER NUMBER	LF500013-ESI-DOG-NOT-0001

Dogger Bank A Export Cable Installation

LOCATION DESCRIPTION		Dogger Bank A Offshore Windfarm, Export Cable Corridor
COORDINATES WGS 84	DBA Export Cable Corridor	See Table 1 below
START DATE/TIME		14/04/2022
END DATE/TIME		02/06/2022

Description of Hazard/Operation

The cable laying vessel, **NKT Victoria**, will install the Dogger Bank A export cable in the Southern North Sea in two sections. In addition, concrete mattresses will be installed at the Langede and SEAL pipeline crossing.

The work will be performed in two Campaigns, starting on the 14th April 2022 and continuing until approximately 2nd June 2022. The work will be continuous, 24 hours a day. Coordinates and chart of the route are provided below.

During the full Cable lay operation (including period when NKT Victoria has left site to pick up the campaign 2 cable) until the cable has been protected by means of burial or rock placement, the construction working corridor will remain closed for any static fishing, anchoring or use of other equipment with seabed intervention.

The first campaign will start with installation of concrete mattress at the Langede pipeline crossing on the 14th April. The mattresses will be installed by NKT Victoria immediately prior to cable installation. A guard vessel will be in place at crossing location as soon as the mattresses have been installed.

Starting from the landfall site, The **NKT Victoria** will then surface lay the export cable in a seaward direction to approx. KP70. After completing the first cable lay, she will leave site to pick up the second cable.

The second campaign will start around the 9th May 2022, with installation of concrete mattresses at the SEAL pipeline crossing. The cable laying operation will be initiated by jointing the campaign 1 cable to the cable in campaign 2, followed by cable lay towards Dogger Bank A Wind Farm. The end of the cable will be temporarily wet stored on the seabed until the installation of the offshore platform and later pull-in in 2023.

During operations the NKT Victoria will be restricted in its ability to manoeuvre as defined under COLREGs (International Regulations for Preventing Collisions at Sea 1972) and will display the appropriate day shapes and lights. The vessel will also transmit an Automatic Identification System (AIS) message.

NOTICE TO MARINERS

It is requested that all vessels maintain a minimum of 1.5Nm separation distance from the Cable laying vessel and pass at reduced speed. fishing gear or other equipment with seabed intervention should not be deployed when approaching the working corridor.

An Offshore Fisheries Liaison Officer will be onboard NKT Victoria to provide support and coordination to fishing vessels, please see contact details below.

In the period between cable lay and cable burial, or protection by rock placement, the cable will be exposed on the seafloor. During this time the cable is sensitive to any external impact and constitutes a snagging risk for anchoring, fishing gear or other equipment with seabed intervention.

To protect the cable in the 500m working corridor, guard vessels will be deployed along the route (described in a separate NtM). The guard vessels will contact vessels approaching within 1.5Nm.

Contact Details

Marine Coordination Contact	John Bray John.bray@sse.com
Fisheries Liaison Officer (FLO) CONTACT	Alex Winrow-Giffin, Brown & May Marine Ltd Alex@brownmay.com Tel: 01379 870181 Mob: 07760 160039 Zoë Lawrence - Brown & May Marine Ltd zoe@brownmay.com Mob: 07923 138175
Offshore Fisheries Liaison Officer (OFLO)	Campaign 1 – 17.04.2022 – 30.04.2022 Micheal Irvine Tel: +31 6404 20317 Email: starvingsid@hotmail.com Campaign 2 – 18.05.2022 – 02.06.2022 Chris Williams Mobile: +44 7707 770571 Email: willc2814@gmail.com
Vessel Shore Contact	David Winda (NKT DPA) Mobile: +46 (0)705 437191 Email: David.Winda@nkt.com

Supporting Information

Vessel – NKT Victoria		Contact Details		
	Call Sign	LAWV7		
	MMSI	257016000		
	IMO	9791016		
	Vessel Details			
	Length	140M		
	Beam	29,6M		
	Draft	Summer draft 8,0M		
	Vessel Contact	V-sat: +47 22 40 81 10 Mobile: +47 46 18 51 45		

NOTICE TO MARINERS



Table1 Coordinates of the Installation Working area - Please note: The coordinates presented below represent a simplified centreline. The extent of the planned cable installation is +/-100m either side of the route, however a wider working area (+/-450m either side of the route) is expected to account for turning radius, crossings, approaches to the nearshore and the Offshore Platform location.

ID	Degrees Decimal Minutes	
	Latitude (WGS 84)	Longitude (WGS 84)
1 (Nearshore)	54°00.282'N	000°13.012'W
2	54°00.455'N	000°11.533'W
3	54°00.429'N	000°10.931'W
4	54°03.102'N	000°00.788'E
5	54°03.600'N	000°01.301'E
6	54°03.803'N	000°02.874'E
7	54°04.569'N	000°03.028'E
8	54°06.099'N	000°05.499'E
9	54°08.000'N	000°12.106'E
10	54°08.970'N	000°13.279'E
11	54°10.844'N	000°18.926'E
12	54°14.297'N	000°27.019'E
13	54°15.388'N	000°28.232'E
14	54°15.285'N	000°28.964'E
15	54°15.614'N	000°29.864'E
16	54°25.876'N	000°38.494'E
17	54°27.155'N	000°39.057'E
18	54°29.917'N	000°43.535'E
19	54°36.977'N	000°52.296'E
20	54°38.203'N	000°54.450'E
21	54°45.004'N	001°13.429'E
22	54°46.679'N	001°30.266'E
23	54°47.791'N	001°35.394'E
24	54°47.935'N	001°37.680'E
25	54°46.881'N	001°41.153'E
26	54°47.496'N	001°45.504'E
27	54°47.291'N	001°46.521'E
28	54°47.410'N	001°48.787'E
29 (Offshore)	54°46.998'N	001°51.603'E

NOTICE TO MARINERS

DOGGER BANK WIND FARM

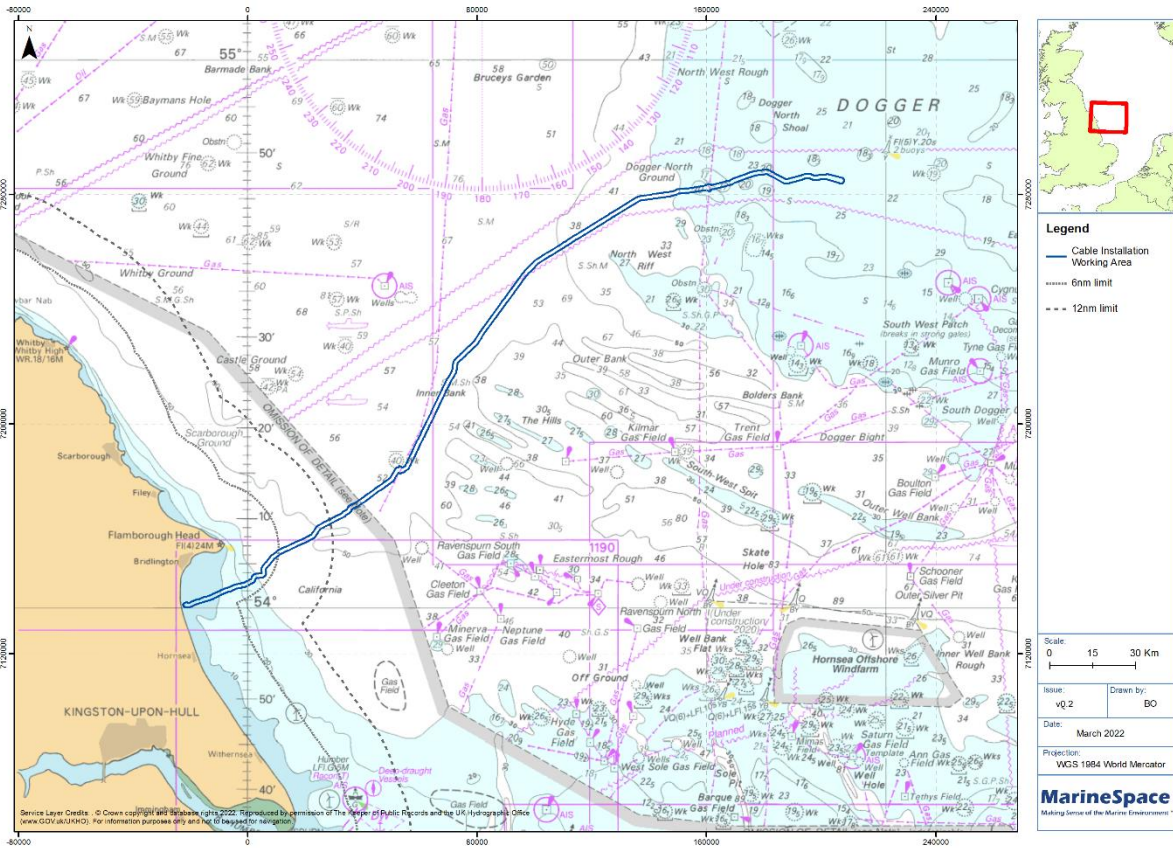

Figure 1: Cable Installation Working Area Overview

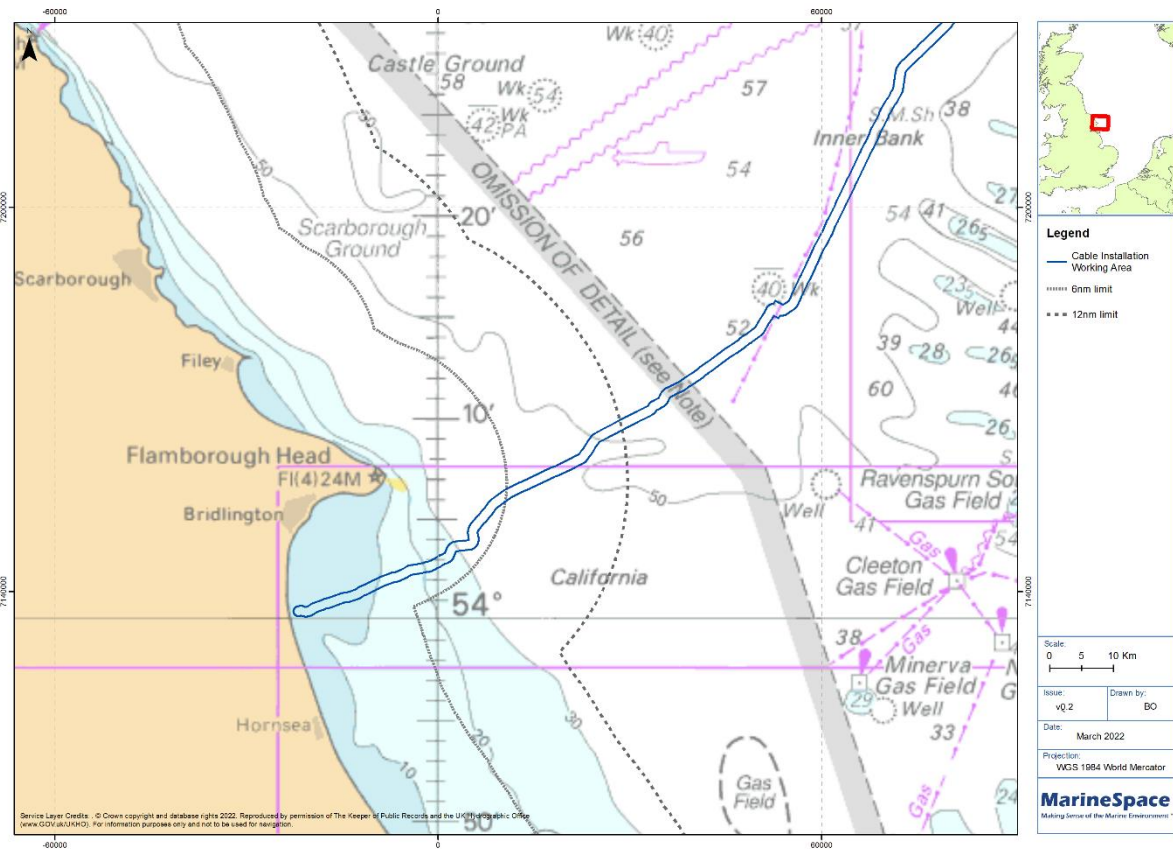

Figure 2: Cable Installation Working Area Inshore